



Multi-direction  
Reach trucks

# SH RANGE



- Combined front and siders providing exceptional versatility—suitable for long load and pallet handling
- Seated multi-direction trucks able to rotate about their centre in either direction, minimising end-of-aisle and overall space needs
- Available with a wide choice of deck depths and lift heights
- All Sidetrackers will operate outside on any reasonable surface
- Designed for free-ranging or guided aisle operation
- Ideal for tool handling and special applications in confined areas
- Capacities from 3200kg to 4100kg

# TECHNICAL DATA

## BRAKES

In addition to power braking, there is a self adjusting hydraulic disc brake system

## STEERING

Twin axel powered rack and pinion steering has overload and kick-back protection

## REACH

Speed controlled and hydraulically traversed. Tracks have replaceable wear strips and adjustment

## TRANSMISSION

Fully overload protected high torque hydrostatic transmission with infinitely variable speed and power braking

## POWER

Battery powered twin electro hydraulic units automatically run singly or together to suit the demand. With either unit out of commission, the truck still remains fully operational on the other. A tremendous reliability advantage, which is particularly important in one truck installations

## MASTS

A full range of mast types are available—Single, duplex, triple & full free lift

## FORKS

Options: Sizes, configuration and attachments. Hydraulic tilt on vertical mast. Manual or fully synchronised hydraulic spread

## PERFORMANCE

Travel speed up to 12km/h, gradients 12%, lift speeds up to 18m/min

## STABILITY INDICATOR

A zoned indicator gives operators clear warning of truck instability through excess weight or load centre

## CONTROL

All functions have infinitely variable control and are ergonomically placed and clearly identified

## WHEELS

Special high-grip polyurethane tyred drive wheel 360mm diameter. Load wheels 250mm diameter polyurethane tyred, twin mounted with differential action giving exceptionally long life. An extended range of wheel sizes and tyre configurations is also available.

## DIMENSIONS

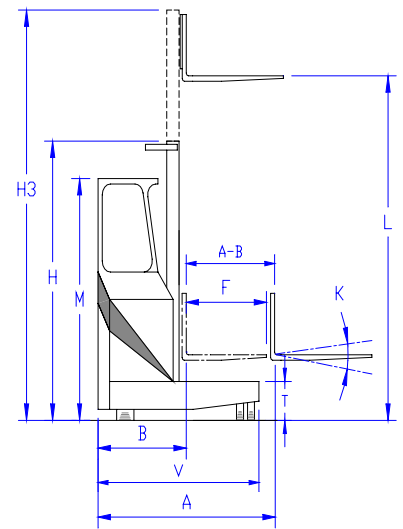
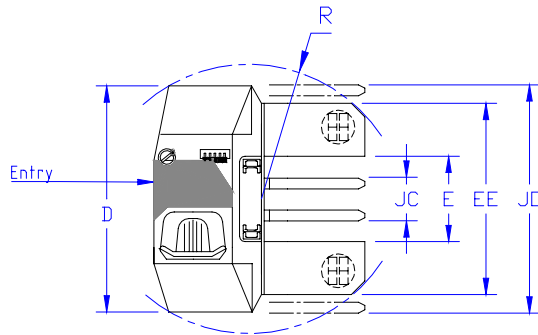

MODEL		SH 32 A	SH32 B	SH32 C	SH32 D	SH41 C	SH41 D
CAPACITY		3200 kg	3200 kg	3200 kg	3200 kg	4100 kg	4100 kg
Load Centre		300	400	500	600	500	600
Rear to fork face extended	A	1750	1965	2155	2355	2185	2385
Rear to fork face retracted	B	1070	1070	1085	1085	1120	1120
Reach traverse	A-B	680	895	1070	1270	1065	1265
Front wheel to fork face	C	343	343	343	343	370	370
Overall width	D	2080	2080	2080	2080	2080	2080
Leg internal gap (up to 1600)	E	785	785	785	785	800	800
Leg width to fork face	EE	1760	1760	1760	1760	1810	1810
Forks length	F	600	800	1000	1200	1000	1200
Forks width	G	100	100	100	100	150	150
Forks thickness	H	50	50	50	50	50	60
Fork spread (hyd. Or man.) Closed	JC	630	630	630	630	750	750
Fork spread (hyd. Or man.) Open	JO	2000	2000	2000	2000	2150	2150
Fork tilt angle degrees up	K	5	5	5	5	5	5
Fork tilt angle degrees down	L	2	2	2	2	2	2
Head guard height	M	2210	2210	2210	2210	2210	2210
Spin radius (maximum)	R	1435	1455	1500	1630	1525	1680
Ground clearance	S	100	100	100	100	100	100
Chassis leg height	T	356	356	356	356	410	410
Chassis length	V	1675	1890	2080	2280	2110	2310
Average guided aisle width nominal rack/load depth		1830	1990	2170	2410	2250	2550
		610	810	1000	1220	1000	1220

All dimensions in mm

See separate datasheets for other Sidetracker multi-directional trucks

We reserve the right to carry out technical modifications and improvements



Station Road Industrial Estate, Clowne, Derbyshire, S43 4AB  
**Telephone: 01246 810655 Fax: 01246 812015**  
[www.sidetracker.co.uk](http://www.sidetracker.co.uk)

Multi-direction Reach trucks  
**SH RANGE**

